

Questions?

If you have any questions, please contact your doctor/GP or our Customer Contact Centre. The RHMDC Customer Contact Centre is available from Monday to Friday, from 8 a.m. to 5 p.m., tel. 088 260 4000.

STD test - urine

This test serves to diagnose sexually transmitted diseases (STDs). To do the test, you must collect a sample of the first part of your urine stream. You can collect this sample at any moment during the day.

Instructions for STD test - urine

A. Package content

- Instruction leaflet
- Request form
- Tube
- Pipette
- White bag
- Plastic bag
- Return envelope

B. Important

Read the explanation in full
Carry out steps 1 to 13.

Do not open the tube until you are ready to start the test. Ensure that you have not passed urine for at least 1 hour, before you collect the urine for the test.

C. Preparation

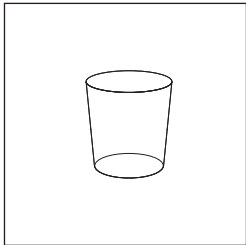

1. You will need a clean and dry jar to pass urine into.

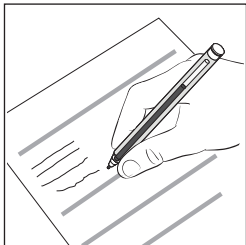

2. Check whether your data have been entered onto the request form and if necessary complete them. On the request form, note the test date and time when you collected the urine.



3. Wash your hands using water and soap. Dry your hands with a clean towel. Try to work as cleanly as possible.

D. Collecting urine

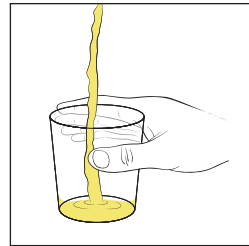

4. Collect the first stream of urine in the jar. Then carry on passing urine into the toilet.

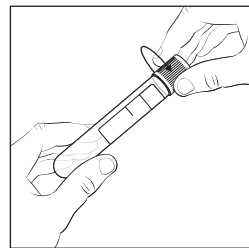

5. Take the tube and remove the lid.

E. Putting urine into the tube

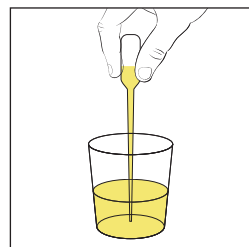

6. Take the pipette and the jar containing the urine. Stick the tip of the pipette into the urine. Squeeze the top of the pipette and let go. The urine will be sucked into the pipette.

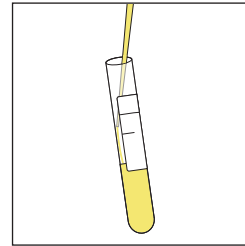

7. Stick the pipette into the tube. Squeeze the top of the pipette. The urine will flow into the tube.

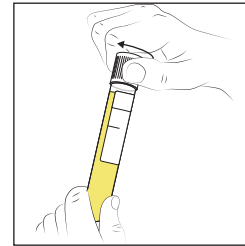

8. The tube must be filled to the top of the sticker with urine. Twist or push the lid on firmly.

F. Wrap and send

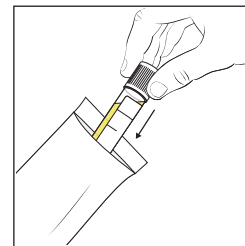

9. Place the tube into the white bag.

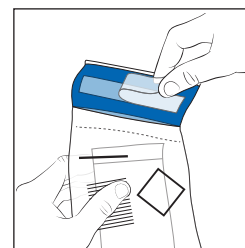

10. Place the white bag with the tube into the special plastic bag (Safetybag). Close the bag using the adhesive strip.

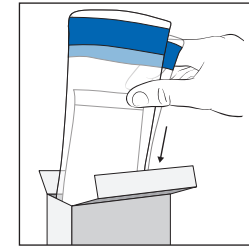

11. Place the well-sealed Safetybag in the box and close the box.

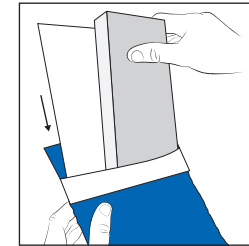

12. Place the box and your doctor's request form into the return envelope. Close the envelope using the adhesive strip.



13. Important: You must post the return envelope the same day*, before the last collection. You do not need a stamp.

* If you are unable to send the envelope within 24 hours, store the material in the fridge until you are able to send it.